

# STC Socket Series

## PRODUCT DESCRIPTION

The STC Socket Series was designed as a full product line featuring high performance and high endurance for most applications and design flexibility covers QFP to FBGA. Depending on customer applications, this STC Socket Series can operate at bandwidth up to 12.5 GHz, and reliable up to 100,000 operations. Conventional Pogo and L-Contact are available for this STC Socket series.

## SPECIFICATIONS

STC Socket Series		
Parameters	Unit	
<b>Physical properties</b>		
Maximum Package Size	mm x mm Max	Customers' specified
Housing Body Type	mm x mm	Customers' specified
Applicable Probe	mm	Customers' specified
Available Pitch	mm	0.3 to 2.54
Holding Type		Clam shell/One-touch/Fixed
Mechanical life	cycle	100,000
<b>Electrical properties</b>		
Contact Resistance	mΩ	100
Carry current	A	1
<b>Other</b>		
		DC to high RF device
		Capable for device contact sensor
		Floating structure available**

Spring Probe / L-contact High Efficiency Socket



FBGA Socket



LGA Socket

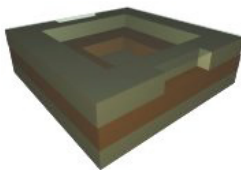

BGA Socket

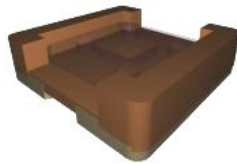

BGA Socket

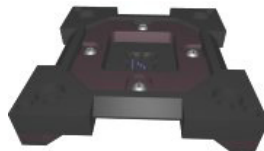

QFP Socket

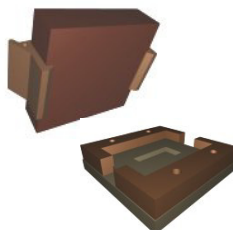

BGA Socket

Applicable Probes

scale: 1mm

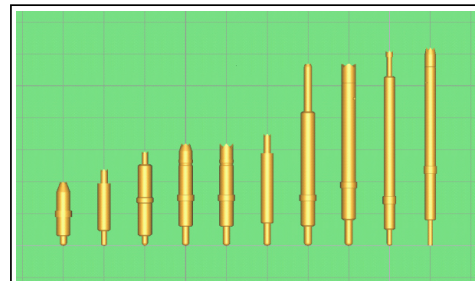

Applicable L-Contact

scale: 1mm

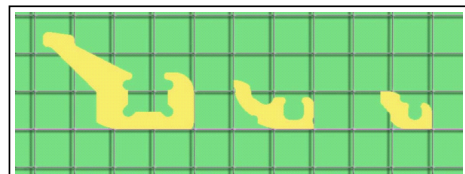

\*\* applicable only 3mm or longer probes